

Spray Nozzles

# Accessories

**DELAVAN.**  
Spray Technologies  
www.delavan.co.uk



## Standard Threaded Nozzle Bodies and Caps

These are designed to accept any standard flanged tip from the standard nozzle range.



### STANDARD THREADED NOZZLE BODIES SELECTION CHART - BSP THREADS

Thread size BSP	Material	Male	Female	Cap thread size	Cap number
M or F 1/8	Brass	A320110016	A320120015	3/8" BSPP	A292830013
M or F 1/8	Stainless steel 303	A320110024	A320120023	3/8" BSPP	A292830021
M or F 1/4	Brass	A320130014	A320140013	3/8" BSPP	A292830013
M or F 1/4	Stainless steel 303	A320130022	A320140021	3/8" BSPP	A292830021
M or F 3/8	Brass	A320160011	A320170010	3/8" BSPP	A292830013
M or F 3/8	Stainless steel 303	A320160029	A320170028	3/8" BSPP	A292830021

### STANDARD THREADED NOZZLE CAP SELECTION CHART - NPT THREADS

Thread size NPT	Material	Male	Female	Cap thread size	Cap number
M or F 1/8	Brass	W203330011	-	11/16" - 16 UN	A011650015
M or F 1/8	Stainless steel 303	W028210034	-	11/16" - 16 UN	A011650031
M or F 1/4	Brass	A011670013	A011690011	11/16" - 16 UN	A011650015
M or F 1/4	Stainless steel 303	A011670039	W199020030	11/16" - 16 UN	A011650031
M or F 3/8	Brass	A507010013	A507020012	11/16" - 16 UN	A011650015
M or F 3/8	Stainless steel 303	A507010021	A507020020	11/16" - 16 UN	A011650031
M 1/4	Nylon	A084740016	-	11/16" - 16 UN	A084750015

## Dovetail Nozzle Bodies

### Features:

- 1/8", 1/4" & 3/8" Dovetail bodies for use with LD Tip
- 3/4" & 1/2" Dovetail bodies for use with AD Tip
- High-pressure caps available for all bodies in LD range



Please note:- Welding Body version available if required.

### DOVETAIL NOZZLE BODIES

Type	Brass	Use Brass Cap No	Stainless Steel	Use S/S Cap No
1/4" BSP LDM Body	X	W00105-2	X	W00105-1
1/4" NPT LDMX Body	X	W00105-2	X	W00105-1
3/8" BSP LDM Body	X	W00105-2	X	W00105-1
3/8" NPT LDMX Body	X	W00105-2	X	W00105-1
1/2" BSP ADM Body	X	W06248-1	X	W06248-3 X
1/2" NPT ADMX Body	X	W06248-1	X	W06248-3
3/4" BSP ADM Body	X	W06248-1	X	W06248-3
3/4" NPT ADMX Body	X	W06248-1	X	W06248-3
LDW Welding Nipple Body	X		X	W00105-1
ADW Welding Nipple Body			X	W06248-3

## Nozzle Sockets

Used for welding or brazing to spray pipe/manifold assemblies to enable Male threaded nozzles to be fitted.

### Features:

- Available with female BSPP threads only
- Available in Brass, Stainless Steel and Mild Steel
- Refer to chart for pipe drilled hole size

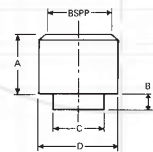

### NOZZLE SOCKETS SELECTION CHART

HNS number	Thread Size	Material	Part number	A	B	C	D
125	1/8"	Brass	W003510010	12,7	3,2	9,1	14,3
125	1/8"	Stainless	W003510036	12,7	3,2	9,1	14,3
250	1/4"	Brass	W003520019	15,9	3,2	15,1	19,1
250	1/4"	Stainless	W003520035	15,9	3,2	15,1	19,1
375	3/8"	Brass	W003530018	19,1	3,2	15,1	25,4
375	3/8"	Stainless	W003530034	19,1	3,2	15,1	25,4
500	1/2"	Brass	W003540017	22,3	4,8	21,8	31,8
500	1/2"	Stainless	W003540033	22,3	4,8	21,8	31,8
750	3/4"	Brass	W003550016	22,3	4,8	21,8	31,8
750	3/4"	Stainless	W003550032	22,3	4,8	21,8	31,8
1000	1"	Brass	W003560031	25,4	6,4	31,4	38,1
1000	1"	Stainless	W003560031	25,4	6,4	31,4	38,1

Spray Nozzles

# Accessories

## Eyelet Bodies

Connect nozzles to pipe or hose

**Features:**

- Delavan eyelets offer the most economical method of attaching spray nozzles to pipe systems
- Easy installation; drill pipe or tube and clamp on eyelet
- Deliver high flow rate with minimum pressure drop
- Varied outlet sizes accept all standard flanged nozzle tips and filters or special swivel nozzles
- Design provided leak-proof service

**Construction and Materials:**

- One-piece design, hinged bridge, locking screw
- Polypropylene/Nylon

### EYELET BODIES SELECTION CHART

NB pipe size	Body Thread	Eyelet Part No.	Drill Hole Size	O Ring Part No.
1/2" Poly	3/8 bsp	W060450001	10.3mm	W162503103
3/4" Poly	3/8 bsp	W060460000	10.3mm	W162503103
1" Poly	3/8 bsp	W060430003	10.3mm	W162503103

### AP BALL JET NOZZLE SELECTION CHART

Nozzle number	Spray Angle 40°	50°	65°	80°
AP 10			x	x
AP 15		x	x	x
AP 20		x	x	x
AP 25	x	x	x	x
AP 30		x	x	x
AP 40		x	x	x
AP 50		x	x	x
AP 60		x	x	



Eyelet Body

## Flow Rate per Nozzle

Nozzle number	Flow Rate in Litres / Min at Bar G									Flow Rate in GAL / Min at PSIG							
	0.7	1	1.5	2	2.5	3	3.5	4	Colour Code	10	15	20	30	40	50	60	Colour Code
AP 10	1.9	2.23	2.84	3.13	3.49	3.93	4.24	4.46	Tan	0.5	0.6	0.72	0.85	1	1.1	1.8	Tan
AP 15	2.84	3.44	3.64	4.21	4.71	6.16	6.65	6.7	Light blue	0.75	0.91	1.1	1.11	1.5	1.7	1.77	Light blue
AP 20	3.8	4.46	5.68	6.25	6.99	8.05	8.69	9.37	Light Green	1	1.18	1.4	1.65	2	2.3	2.48	Light Green
AP 25	4.75	5.58	7.1	7.81	8.73	10.06	10.87	11.71	Maroon	1.2	1.53	1.8	2.12	2.5	2.8	3.01	Maroon
AP 30	5.95	6.7	8.52	9.82	10.98	11.84	12.79	13.84	Blue	1.5	1.77	2.2	2.59	3	3.4	3.66	Blue
AP 40	7.78	9.37	10.89	12.05	13.47	15.62	16.87	18.3	Red	2	2.48	2.8	3.18	4	4.4	4.83	Red
AP 50	9.61	11.61	13.73	16.07	17.97	19.89	21.48	22.77	Brown	2.5	3.07	3.5	4.25	5	5.6	6.02	Brown
AP 60	11.44	13.84	16.57	19.2	21.47	23.67	25.57	27.23	Gray	3	3.66	4.2	5.07	6	6.7	7.19	Gray

### BALL SWIVEL EYELETS

NB pipe size	Body Material	Working pressure	Part number	Drill size hole	Seal
11/4"	Poly	8.7-bar	W100349981	20mm	W10371
11/2"	Poly	8.7-bar	W100349998	20mm	W10371



Clamp-on Ball Swivel Eyelet

### SC CLIP-ON-EYELET

NB pipe size	Body Material	Working pressure	Part number	Drill size hole	Seal
1" SC	Poly	6-bar	W167220000	13.5mm	W31350
11/4" SC	Poly	4-bar	W132530038	20mm	W31350
11/2" SC	Poly	3-bar	W132540037	20mm	W31350



SC Eyelet

## Tip Filters

- Standard Flanges – for use with standard flanged nozzles
- Ball Check – for use with standard flanged nozzles to help stop dripping after pressure shut off
- Threaded – for use with WM, WG and WA nozzle range

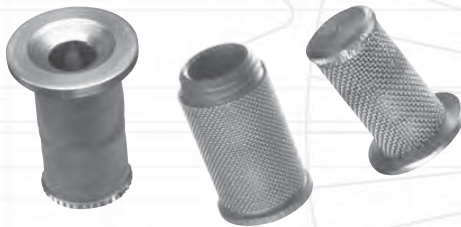

### TIP FILTERS SELECTION CHART

Mesh size	Material	Flange	Ball Check Strainer	Threaded (SC)	Flange (FC)
24	Brass	-	A352880064	-	-
24	Stainless	-	A352880098	-	-
40	Brass	-	-	W000891017	-
40	Stainless	-	-	W000893013	-
50	Brass	A281750032	A352880015	-	-
50	Stainless	A281750016	A352880072	-	-
80	Brass	-	-	W000891025	-
80	Stainless	-	-	W000893021	-
100	Brass	A281750040	A352880023	-	-
100	Stainless	A281750024	A352880080	-	-
150	Brass	-	-	-	-
150	Stainless	-	-	-	-
200	Brass	A281750073	-	W000891033	-
200	Stainless	A281750107	A352880106	W000893039	-
60	Poly	-	-	-	W184360011
100	Poly	-	-	-	W184360029

## Pipe Support Clips & Clamps

### Features:

- Quick and secure method of attaching plastic pipes to sheet metal or hangers
- Glass reinforced polypropylene for strength and chemical resistance
- Sizes to fit 1/2", 3/4", 11/4" and 11/2" nominal bore pipe sizes (clips 11/4 and 11/2 only)
- Support fixing screw will not turn when locking nut is being screwed down
- Accepts fixing screws of varying lengths



### Construction and Materials:

- Clip is one-piece body with spring clip. Clamp is one-piece with hinged bridge piece
- Both with glass reinforced body. Clip has stainless steel spring clip and Clamp has stainless steel hinge pin, screw insert and fixing screws

### PIPE SUPPORT CLAMPS

NB pipe size	Body Material	Part number	Screw Size
1/2"	Poly	W108920015	M8 x 45mm
3/4"	Poly	W108920023	M8 x 45mm
11/4"	Poly	W108920031	M10 x 40mm
11/2"	Poly	W108920049	M10 x 40mm

### PIPE SUPPORT CLIPS (SC TYPE)

NB pipe size	Body Material	Part number	Screw Size
11/4"	Poly	W137720030	M10 x 40mm
11/2"	Poly	W137730039	M10 x 40mm

### Typical Ordering Instructions:

- W13772 Support Clip to fit 1.25" NB Pipe or W10892-2 Pipe  
Clamp to fit 1/2" NB Pipe

Contact our Helpline or your local distributor for further information  
Tel: +44 (151) 424 6821 or inside USA Toll Free: 1-800 Delavan  
E-mail: delavanspray@goodrich.com or sales@delavan.co.uk

Spray Nozzles

# Accessories

## Adaptors

**Features:**

- 90° adaptor for positioning of nozzles
- Available in brass and stainless steel – other materials available to special order

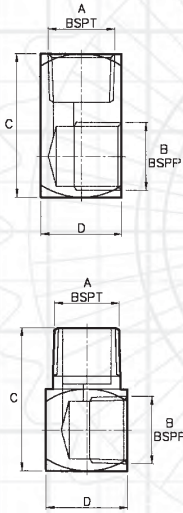

## ADAPTORS SELECTION CHART

Part number Male Adaptor		Part number Male Adaptor		Part number Female Adaptor		Part number Female Adaptor	
Brass	Stainless	Thread Size A	Thread Size B	Brass	Stainless	Thread Size A	Thread Size B
W137130024	W137130016	1/8"	1/8"	W067851011	W067853033		
W000811015	W000812021	1/4"	1/8"	W002162029	W002161013		
W003180020	W003180012	1/4"	1/4"	W004640022	W004640014		
W000822020	W000821014	3/8"	1/4"	W002172028	W002171012		
W003190029	W003190011	3/8"	3/8"	W004630023	W004630015		
W000832029	W000831013	1/2"	3/8"	W002182027	W002181011		
W003200026	W003200034	1/2"	1/2"	W004620024	W004620016		
W000842028	W000841012	3/4"	1/2"	W002190020	W002191010		
W001940029	W001940037	3/4"	3/4"	W001960027	W001960019		
W000852027	W000851011	1"	3/4"	W002202023	W002201017		
W004681026	W004681018	1"	1"	W004700024	W004700016		

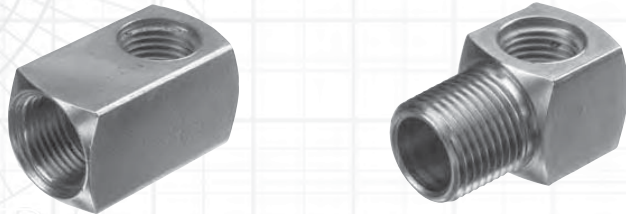

## Adjustable Joint

**Features and Positioning:**

- Facilitates finger-tight nozzle adjustment without disturbing piping system
- Complete 360° radial adjustment and 50° angular adjustment

**Construction and Materials:**

- Available with Male inlet connections and Female outlets in BSP or NPT threads
- Available in Brass and Stainless Steel
- Positive O-ring seal handles pressures up to 35 Bar G

## ADJUSTABLE JOINT SELECTION CHART

Part number	Material	Inlet Thread BSP	Outlet Thread BSP	A	B	C
W091111010	Brass	1/8"	1/8"	28.60	25.40	20.80
W091113016	Stainless	1/8"	1/8"	28.60	25.40	20.80
W091111028	Brass	1/4"	1/8"	28.60	25.40	20.80
W091113024	Stainless	1/4"	1/8"	28.60	25.40	20.80
W091111036	Brass	1/4"	1/4"	34.90	31.80	25.70
W130601120	Poly	1/4"	1/4"			
W091113032	Stainless	1/4"	1/4"	34.90	31.80	25.70
W091111044	Brass	3/8"	1/4"	34.90	31.80	25.70
W130603126	Poly	3/8"	1/4"			
W091113040	Stainless	3/8"	1/4"	34.90	31.80	25.70
W091111051	Brass	3/8"	3/8"	44.50	38.10	31.80
W130604124	Poly	3/8"	3/8"			
W091113057	Stainless	3/8"	3/8"	44.50	38.10	31.80
W091111069	Brass	1/2"	1/2"	55.60	44.50	31.80
W130607127	Poly	1/2"	1/2"			
W091113065	Stainless	1/2"	1/2"	55.60	44.50	31.80
W091111077	Brass	3/4"	3/4"	61.10	50.80	38.00
W091113073	Stainless	3/4"	3/4"	61.10	50.80	38.00
W091111085	Brass	1"	1"	75.00	70.00	60.00
W091113081	Stainless	1"	1"	75.00	70.00	60.00

